

## STAINLESS ROLLER CHAIN

### 1. Stainless Roller Chain SUS Series

This chain is made of 304 (austenitic) stainless steel. This chain has excellent corrosive resistance and very low magnetic permeability.

This chain is good for general acid, alkali and water. Heat resistance.

### 2. Stainless Roller Chain SAC Series

This chain is made of 316 (austenitic) stainless steel. This is better in corrosion resistance than SUS Series and non-magnetic. Spring clips and cotters used are made of 304 stainless steel. Heat resistance.

### 3. Stainless Roller Chain SPH Series

The pin, bush and roller of this chain are made of 600 Series precipitation hardened stainless steel with link plate of 304 stainless steel. Spring clips and cotters used are made of 304 stainless steel. Magnetic.

Better wear resistance. The working load of this chain is 1.5 times SUS Series.

### 4. Super Shield Chain

A tough protective coating is baked onto the chain. This chain is better than nickel plated chain in corrosion resistance. The tensile strength is slightly lower than standard roller chain. Please avoid using this chain for the applications requiring resistance to acids and in direct contact with food. When you need a chain for corrosion resistance to salt water, rain water, etc, use SUPER SHIELD.

### 5. Nickel Plated Chain

Assembled from special nickel plated components. This chain with good corrosion resistance and beautiful surface appearance is used for food machinery, office machinery, etc.

### 6. Cold Resistance Chain K Series

This chain is identical in dimension with standard roller chain but can be used at a temperature of  $-30^{\circ}\text{C}$ ~ $60^{\circ}\text{C}$ .

# ANSI STAINLESS ROLLER CHAIN

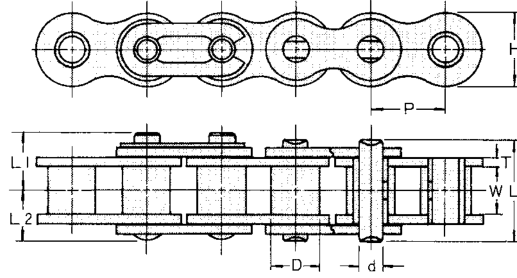

UNIT Upper:inch  
Beneath:mm

OCM Chain No.	Pitch	Roller Diam.	Width between L.P.	Link Plate		Pin Diam.	Pin			Max Working Load	Approx Weight
	P	D	W	H	T	d	L	L1	L2	Lb/kgf	Lb/ft kg/m
OCM 15SUS	0.188	0.098	0.094	0.173	0.022	0.064	0.224	0.154	0.114	11	0.062
	4.7625	2.48	2.38	* 4.40	0.57	1.62	5.70	3.90	2.90	5	0.093
OCM 25SUS	0.25	0.13	0.126	0.23	0.03	0.091	0.307	0.189	0.154	26	0.087
	6.35	3.30	3.20	* 5.85	0.75	2.30	7.80	4.80	3.90	12	0.13
OCM 35SUS	0.375	0.2	0.189	0.354	0.049	0.141	0.465	0.264	0.24	66	0.249
	9.525	5.08	4.80	* 9.00	1.25	3.58	11.80	6.70	6.10	30	0.37
OCM 40SUS	0.50	0.312	0.313	0.472	0.059	0.156	0.654	0.402	0.323	99	0.403
	12.70	7.92	7.95	12.00	1.50	3.96	16.60	10.20	8.20	45	0.6
OCM 50SUS	0.625	0.4	0.376	0.591	0.079	0.2	0.819	0.48	0.406	165	0.632
	15.875	10.16	9.55	15.00	2.00	5.08	20.80	12.20	10.30	75	0.94
OCM 60SUS	0.75	0.469	0.5	0.709	0.094	0.234	1.02	0.598	0.5	231	0.941
	19.05	11.91	12.70	18.00	2.40	5.95	25.90	15.20	12.70	105	1.4
OCM 80SUS	1.00	0.625	0.626	0.945	0.126	0.313	1.299	0.76	0.65	397	1.68
	25.40	15.88	15.90	24.00	3.20	7.94	33.00	19.30	16.50	180	2.5
OCM 100SUS	1.25	0.75	0.754	1.181	0.157	0.375	1.701	0.909	0.791	573	2.553
	31.75	19.05	19.15	30.00	4.00	9.53	43.20	23.10	20.10	260	3.8
OCM 120SUS	1.50	0.875	1.006	1.417	0.189	0.437	2.114	1.118	0.996	882	3.696
	38.10	22.23	25.55	36.00	4.80	11.11	53.70	28.40	25.30	400	5.5

Connecting link for 80 and above is cotter type.  
\* indicates bush diameters.

UNIT Upper:inch  
Beneath:mm

OCM Chain No.	Pitch	Roller Diam.	Width between L.P.	Link Plate		Pin Diam.	Pin			Max Working Load	Approx Weight
	P	D	W	H	T	d	L	L1	L2	Lb/kgf	Lb/ft kg/m
OCM 40SPH	0.50	0.312	0.313	0.472	0.059	0.156	0.654	0.402	0.323	154	0.403
	12.7	7.92	7.95	12	1.5	3.96	16.6	10.2	8.2	70	0.6
OCM 50SPH	0.625	0.4	0.376	0.591	0.079	0.2	0.819	0.48	0.406	231	0.632
	15.875	10.16	9.55	15	2	5.08	20.8	12.2	10.3	105	0.94
OCM 60SPH	0.75	0.469	0.5	0.709	0.094	0.234	1.02	0.598	0.5	353	0.941
	19.05	11.91	12.7	18	2.4	5.95	25.9	15.2	12.7	160	1.4
OCM 80SPH	1.00	0.625	0.626	0.945	0.126	0.313	1.299	0.76	0.65	595	1.68
	25.4	15.88	15.9	24	3.2	7.94	33	19.3	16.5	270	2.5

UNIT Upper:inch  
Beneath:mm

OCM Chain No.	Pitch	Roller Diam.	Width between L.P.	Link Plate		Pin Diam.	Pin			Max Working Load	Approx Weight
	P	D	W	H	T	d	L	L1	L2	Lb/kgf	Lb/ft kg/m
OCM 40SAC	0.50	0.312	0.313	0.472	0.059	0.156	0.654	0.402	0.323	99	0.403
	12.7	7.92	7.95	12	1.5	3.96	16.6	10.2	8.2	45	0.6
OCM 50SAC	0.63	0.4	0.376	0.591	0.079	0.2	0.819	0.48	0.406	165	0.632
	15.875	10.16	9.55	15	2	5.08	20.8	12.2	10.3	75	0.94
OCM 60SAC	0.75	0.469	0.5	0.709	0.094	0.234	1.02	0.598	0.5	231	0.941
	19.05	11.91	12.7	18	2.4	5.95	25.9	15.2	12.7	105	1.4
OCM 80SAC	1.00	0.625	0.626	0.945	0.126	0.313	1.299	0.76	0.65	397	1.68
	25.4	15.88	15.9	24	3.2	7.94	33	19.3	16.5	180	2.5

# STAINLESS DOUBLE PITCH ROLLER CHAIN

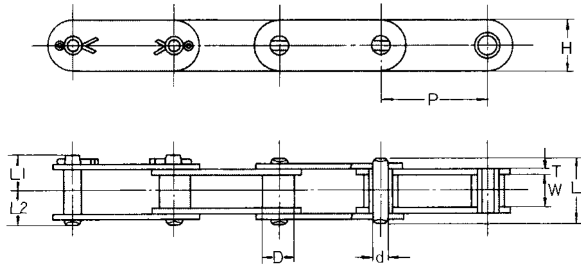

SMALL ROLLER

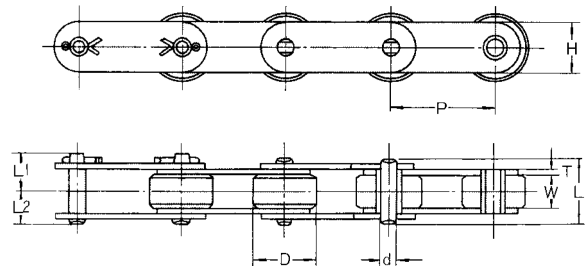

LARGE ROLLER

SMALL ROLLER

UNIT Upper:inch  
Beneath:mm

OCM Chain No.	Pitch		Roller Diam.		Width between L.P.		Link Plate		Pin Diam.			Max Working Load	Approx Weight
	P	D	W	H	T	d	L	L1	L2	Lb/kgf	kg/m		
C2040SUS	1.000	0.312	0.313	0.472	0.059	0.156	0.654	0.402	0.323	99	0.34		
	25.4	7.92	7.95	12	1.5	3.96	16.6	10.2	8.2	45	0.51		
C2050SUS	1.250	0.4	0.376	0.591	0.079	0.2	0.819	0.476	0.409	165	0.58		
	31.75	10.16	9.55	15	2	5.08	20.8	12.1	10.4	75	0.87		
C2060HSUS	1.500	0.469	0.5	0.677	0.126	0.234	1.142	0.669	0.563	231	1.01		
	38.1	11.91	12.7	17.2	3.2	5.95	29	17	14.3	105	1.51		
C2080HSUS	2.000	0.625	0.626	0.945	0.157	0.313	1.437	0.839	0.709	397	1.79		
	50.8	15.88	15.9	24	4	7.94	36.5	21.3	18	180	2.66		

LARGE ROLLER

UNIT Upper:inch  
Beneath:mm

OCM Chain No.	Pitch		Roller Diam.		Width between L.P.		Link Plate		Pin Diam.			Max Working Load	Approx Weight
	P	D	W	H	T	d	L	L1	L2	Lb/kgf	kg/m		
C2042SUS	1.000	0.625	0.313	0.472	0.059	0.156	0.654	0.402	0.323	99	0.58		
	25.4	15.88	7.95	12	1.5	3.96	16.6	10.2	8.2	45	0.87		
C2052SUS	1.250	0.75	0.376	0.591	0.079	0.2	0.819	0.476	0.409	165	0.91		
	31.75	19.05	9.55	15	2	5.08	20.8	12.1	10.4	75	1.35		
C2062HSUS	1.500	0.875	0.5	0.677	0.126	0.234	1.142	0.669	0.563	231	1.47		
	38.1	22.23	12.7	17.2	3.2	5.95	29	17	14.3	105	2.19		
C2082HSUS	2.000	1.125	0.626	0.945	0.157	0.313	1.437	0.839	0.709	397	2.47		
	50.8	28.58	15.9	24	4	7.94	36.5	21.3	18	180	3.68		

Note: Connecting link for C2040/C2042 to C2060H/C2060H is spring clip while C2080H/C2082H and above is cotter type.

OCM Chain No.	OCM Chain No.	Max working load		OCM Chain No.	OCM Chain No.	Max working load	
		kgf	Lbs			kgf	Lbs
C2040-SAC	C2042-SAC	45	99	C2040-SPH	C2042-SPH	70	154
C2050-SAC	C2052-SAC	75	165	C2050-SPH	C2052-SPH	105	231
C2060H-SAC	C2062H-SAC	105	231	C2060H-SPH	C2062H-SPH	160	353
C2080H-SAC	C2082H-SAC	180	397	C2080H-SPH	C2082H-SPH	270	595

Dimensions of SAC and SPH are the same as SUS.

# STAINLESS HOLLOW PIN CHAIN

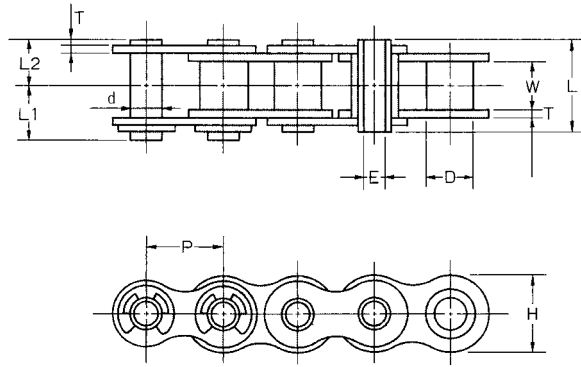

CHAIN IS ROLLERLESS

UNIT Upper:inch  
Beneath:mm

OCM Chain No.	Pitch	Roller Diam.	Width between L.P.	Pin Diam.	Trans Pitch	Pin			Link Plate		Allowable Load	Approx Weight
	P	D	W	d	E (MIN)	L	L1	L2	H	T	Lb/kgf	Lb/ft kg/m
40HP SUS	0.500 12.7	0.312 7.92	0.313 7.95	0.222 5.65	0.157 4	0.63 16	0.362 9.2	0.315 8	0.472 12	0.059 1.5	99 45	0.34 0.51
50HP SUS	0.625 15.875	0.4 10.16	0.376 9.55	0.284 7.21	0.202 5.12	0.799 20.3	0.451 11.45	0.4 10.15	0.591 15	0.079 2	165 75	0.56 0.84
60HP SUS	0.750 19.05	0.469 11.91	0.5 12.7	0.327 8.3	0.236 6	1 25.4	0.559 14.2	0.5 12.7	0.709 18	0.094 2.4	231 105	0.83 1.23
80HP SUS	1.000 25.4	0.625 15.88	0.626 15.9	0.433 11	0.315 8	1.287 32.7	0.703 17.85	0.644 16.35	0.949 24.1	0.126 3.2	397 180	1.48 2.2

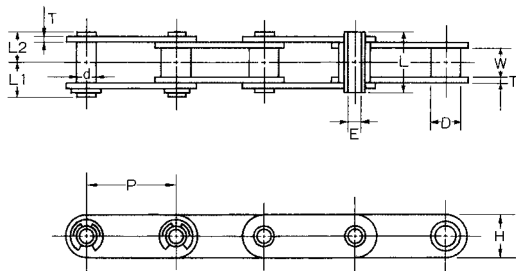

TYPE ROLLERLESS

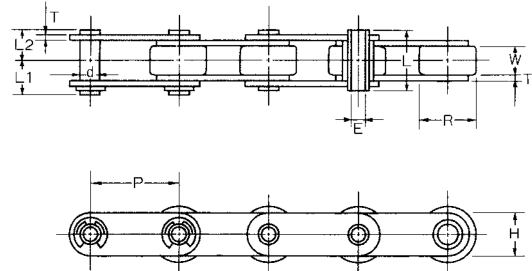

TYPE LARGE ROLLER

UNIT Upper:inch  
Beneath:mm

OCM Chain No.	Pitch	Roller Diam.		Width between L.P.	Pin Diam.		Pin			Link Plate		Allowable Load	Approx Weight	
	P	D	R	W	d	E(MIN)	L	L1	L2	H	T	Lb/kgf	Lb/ft kg/m	
C2040HP-C2042HP SUS	1.000 25.4	0.312 7.92	0.625 15.88	0.313 7.95	0.222 5.65	0.157 4	0.63 16	0.362 9.2	0.315 8	0.472 12	0.059 1.5	99 45	0.3 0.45	0.53 0.79
C2050HP-C2052HP SUS	1.250 31.75	0.4 10.16	0.75 19.05	0.376 9.55	0.284 7.21	0.202 5.12	0.799 20.3	0.451 11.45	0.4 10.15	0.591 15	0.079 2	165 75	0.5 0.74	0.8 1.19
C2060HP-C2062HP SUS	1.500 38.1	0.469 11.91	0.875 22.23	0.5 12.7	0.327 8.3	0.236 6	1 25.4	0.559 14.2	0.5 12.7	0.677 17.2	0.094 2.4	231 105	0.69 1.02	1.15 1.71
C2080HP-C2082HP SUS	2.000 50.8	0.625 15.88	1.125 28.58	0.626 15.9	0.433 11	0.315 8	1.287 32.7	0.703 17.85	0.644 16.35	0.945 24	0.126 3.2	397 180	1.28 1.91	1.98 2.94